

①

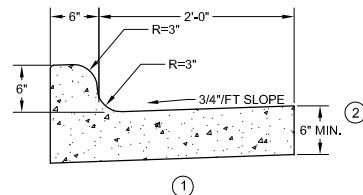

①

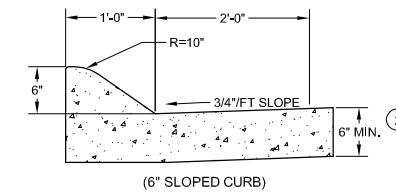

(6" SLOPED CURB)

②

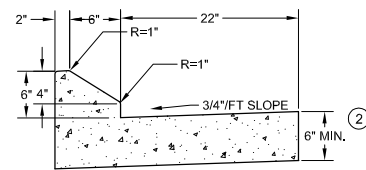

6" SLOPED CURB ①

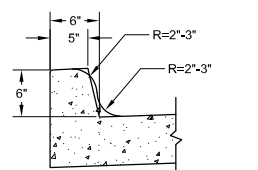

OPTIONAL CURB SHAPE ①

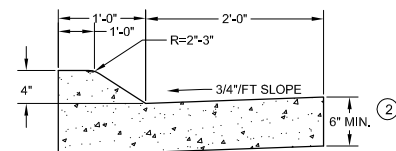

(4" SLOPED CURB) ①

CONCRETE CURB & GUTTER 30"
C### NTS

CONCRETE CURB & GUTTER 36"
C### NTS

KEYED NOTES:

- ① TIE BARS ARE REQUIRED FOR CURB AND GUTTER.
- ② THE BOTTOM OF CURB AND GUTTER MAY BE CONSTRUCTED EITHER LEVEL OR PARALLEL TO THE SLOPE OF THE SUBGRADE OR BASE COURSE PROVIDED A 6" MINIMUM GUTTER GUTTER THICKNESS IS MAINTAINED.

GENERAL NOTES:

LATERAL CONTRACTION JOINTS SHALL BE PLACED AT INTERVALS OF NOT MORE THAN 15' NOR LESS THAN 6' IN LENGTH. THE JOINTS SHALL BE A MINIMUM OF 3" IN DEPTH.

EXPANSION JOINTS SHALL BE PLACED TRANSVERSALLY AT RADIUS POINTS ON CURVES OF RADIUS OF 200' OR LESS, AT ANGLE POINTS, 3' FROM OUTSIDE EDGE OF STORM SEWER INLETS, BETWEEN BACK OF CURB AND CONCRETE SIDEWALK OR DRIVEWAY OR AS DIRECTED BY THE ENGINEER. THE EXPANSION JOINT SHALL BE A ONE PIECE ASPHALTIC MATERIAL HAVING THE SAME DIMENSIONS AS CURB & GUTTER AT THAT STATION AND BE 1/2" THICK.

IN ALL CASES, CONCRETE CURB & GUTTER SHALL BE PLACED ON 6 INCHES MINIMUM OF THOROUGHLY COMPACTED CRUSHED STONE.



Revisions:

No.	Date:	Description:

Graphic Scale



DFD Number

Set Type

Date Issued

8/1/2017

Sheet Number